

SIGNING & PAVEMENT MARKINGS LEGEND

- (A) 4 INCH SOLID WHITE THERMOPLASTIC PAVEMENT MARKINGS
- (B) 4 INCH DOUBLE SOLID YELLOW THERMOPLASTIC PAVEMENT MARKINGS
- (C) 4 INCH SOLID WHITE THERMOPLASTIC PAVEMENT MARKINGS, ANGLED 45 DEG TO EDGELINE, SPACED 5' O.C.
- (D) HIGH VISIBILITY CROSSWALK (6 INCH SOLID WHITE LINE 24" CROSS WHITE LINES SPACED AT 4' O.C.)
- (E) 8 INCH SOLID YELLOW THERMOPLASTIC PAVEMENT MARKINGS, ANGLED 45 DEG TO EDGELINE, SPACED 5' O.C.
- (F) 4 INCH DASHED WHITE THERMOPLASTIC PAVEMENT MARKINGS (2' STRIPE, 4' SKIP)
- (G) 4 INCH DOUBLE DASHED YELLOW THERMOPLASTIC PAVEMENT MARKINGS (2' STRIPE, 4' SKIP)
- (H) STOP LINE - 12 INCH SOLID WHITE THERMOPLASTIC PAVEMENT MARKINGS
- (I) 4 INCH DASHED WHITE THERMOPLASTIC PAVEMENT MARKINGS (3' STRIPE, 9' SKIP)
- (J) 4 INCH BROKEN WHITE THERMOPLASTIC PAVEMENT MARKINGS (10' STRIPE, 30' SKIP)
- (K) THRU ARROW PAVEMENT MARKINGS (9.5' TALL)
- (L) RIGHT ARROW PAVEMENT MARKINGS (8' TALL)
- (M) "ONLY" WORD PAVEMENT MARKINGS (8' TALL)

SYMBOL LEGEND

- EXISTING FIRE HYDRANT
- EXISTING UTILITY POLE /LIGHT POLE /SIGNAL POLE
- EXISTING SIGN POST
- EXISTING SIGN POST TO BE REMOVED
- EXISTING ADA COMPLIANT PED RAMP TO BE REMOVED
- NEW SIGN TO BE INSTALLED ON NEW POST
- NEW SIGN TO BE INSTALLED ON EXISTING POST OR EXISTING SIGNAL /LIGHT POLE
- INSTALL WHITE FLEXPOSTS AS SHOWN 2' FROM THE GORE PERIMETER, SPACED 5' O.C.

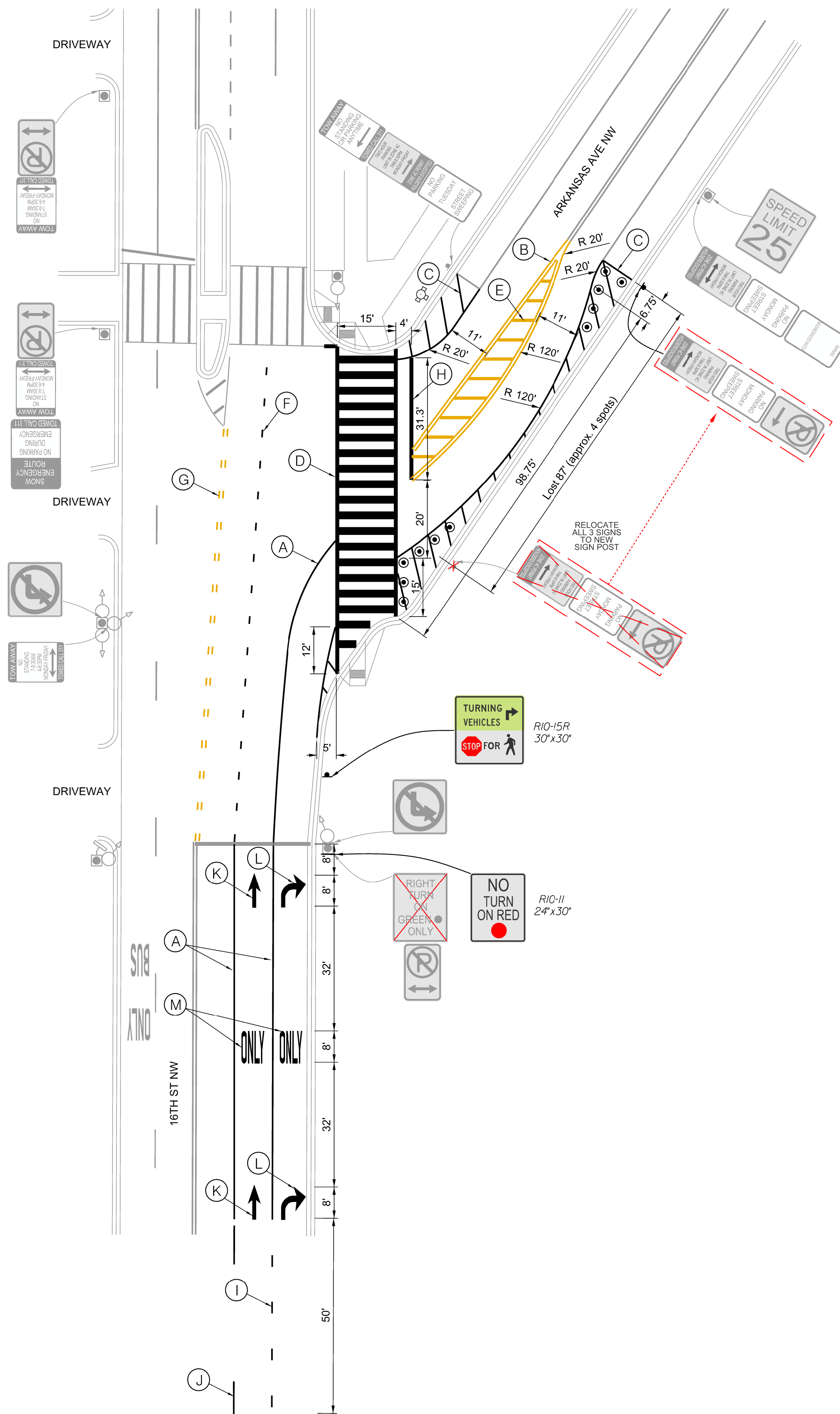

Sam Schwartz
A TYLin Company

NO.	DESCRIPTION	NAME	DATE

D.C. DEPARTMENT OF TRANSPORTATION PROJECT DELIVERY ADMINISTRATION TRAFFIC ENGINEERING AND SAFETY DIVISION	
16TH STREET NW & ARKANSAS AVE NW SAFETY IMPROVEMENTS	PROJECT ENG. <u>JC</u> DESIGNED BY <u>JC</u> CHECKED BY <u>W</u> DRAWN BY <u>JC</u> PROJECT MGR <u>W</u>
PAVEMENT MARKING AND SIGNING LAYOUT PLANS	DIVISION CHIEF
DATE <u>AUGUST 2023</u>	FILE <u> </u>
SHEET <u>1</u> OF <u>3</u>	

STATE	CONTRACT NO.	SHEET NO.	TOTAL SHEETS
D.C.	DCKA-2017-T-0021	2	3

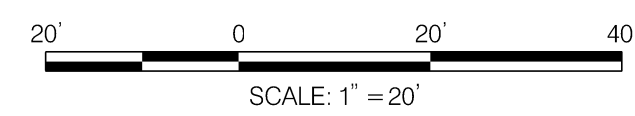
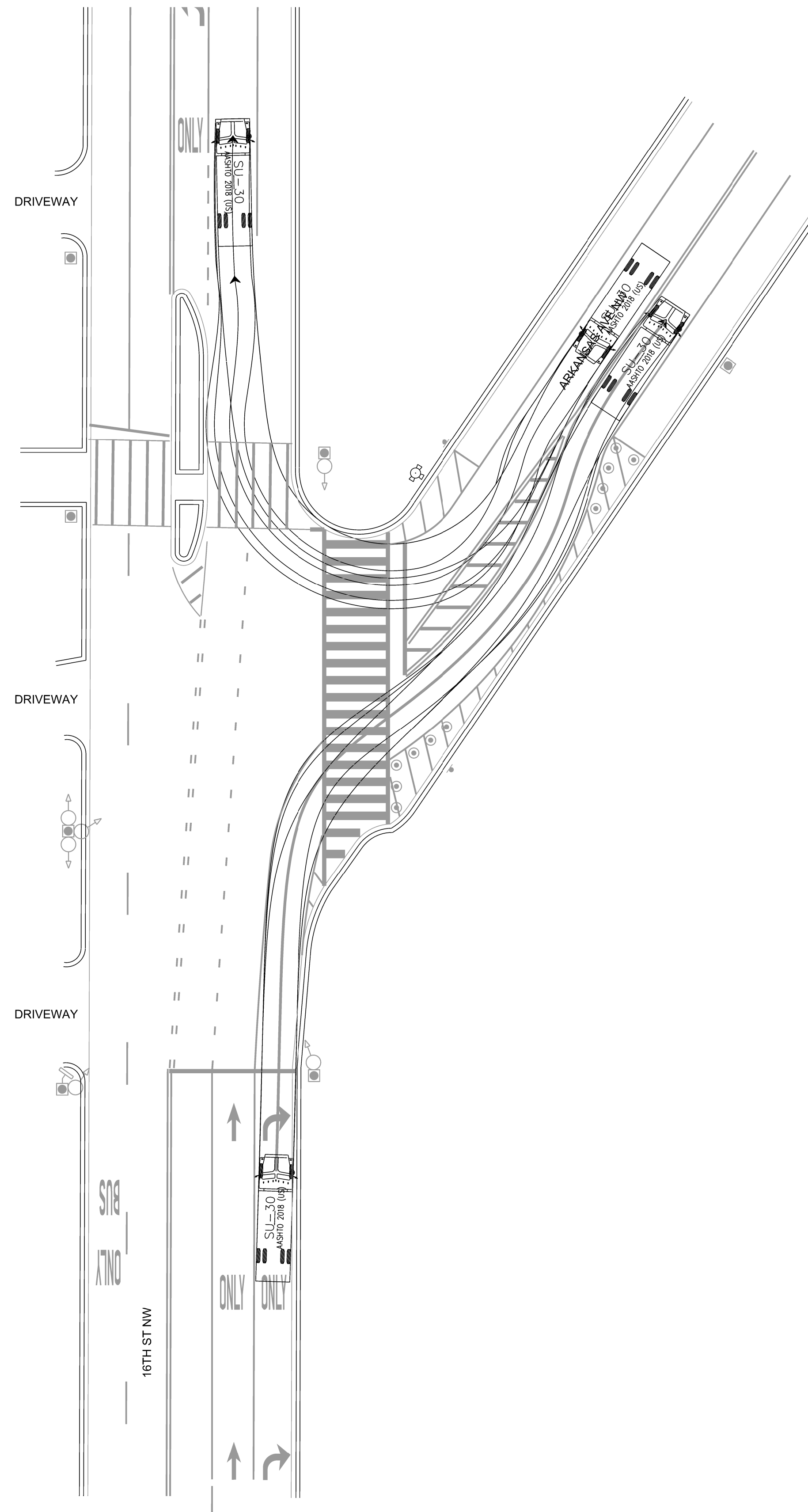

Sam Schwartz
A TYLin Company

NO.	DESCRIPTION	NAME	DATE

D.C. DEPARTMENT OF TRANSPORTATION PROJECT DELIVERY ADMINISTRATION TRAFFIC ENGINEERING AND SAFETY DIVISION	
16TH STREET NW & ARKANSAS AVE NW SAFETY IMPROVEMENTS	PROJECT ENG. <u>JC</u> DESIGNED BY <u>JC</u> CHECKED BY <u>W</u> DRAWN BY <u>JC</u> PROJECT MGR <u>W</u>
TURNING MOVEMENTS	DIVISION CHIEF DATE <u>AUGUST 2023</u> FILE <u> </u> SHEET <u>2</u> OF <u>3</u>

STATE	CONTRACT NO.	SHEET NO.	TOTAL SHEETS
D.C.	DCKA-2017-T-0021	3	3



EXISTING CONDITIONS

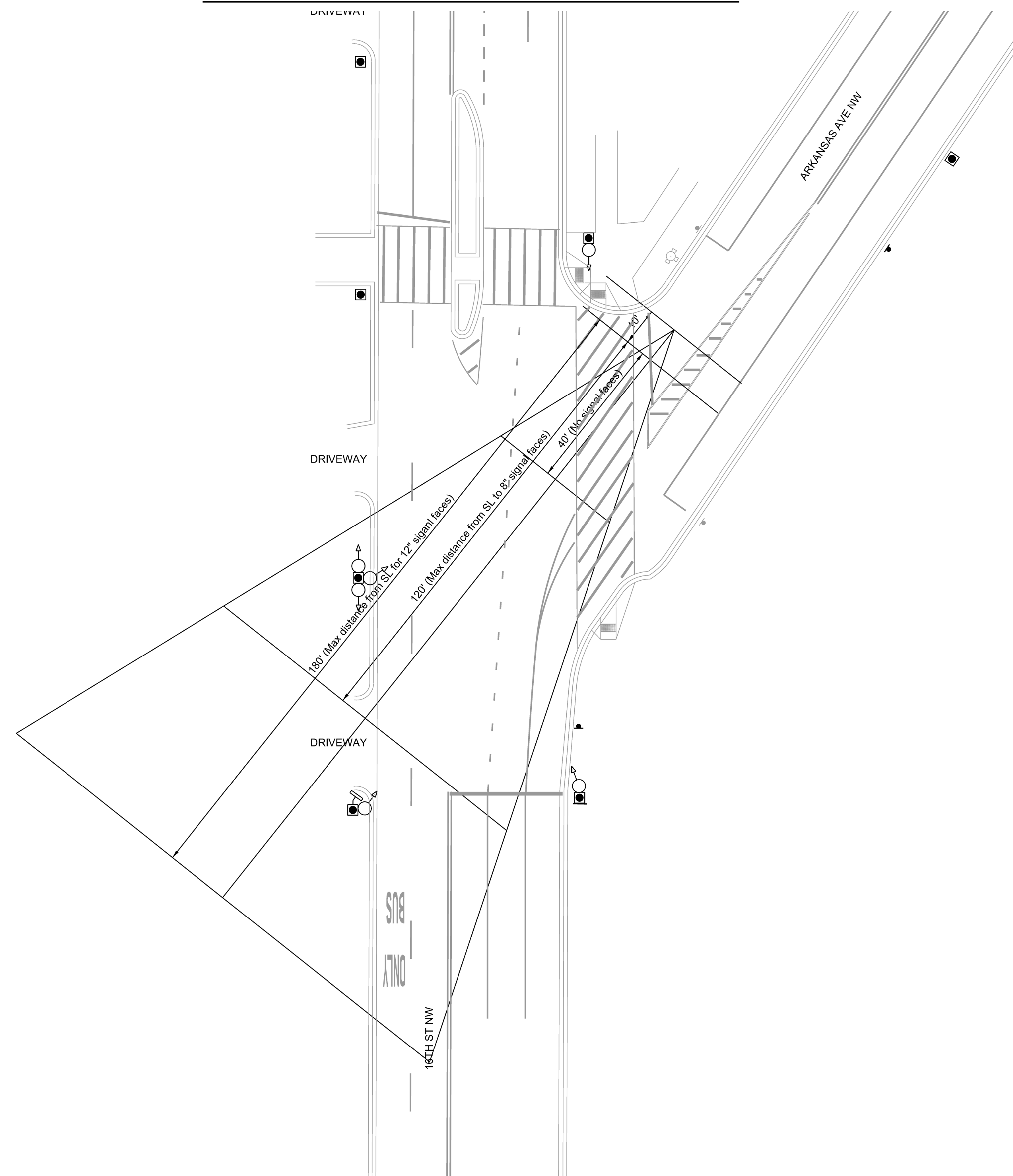

PROPOSED CONDITIONS

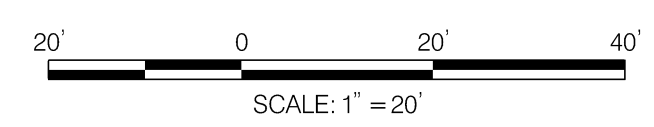
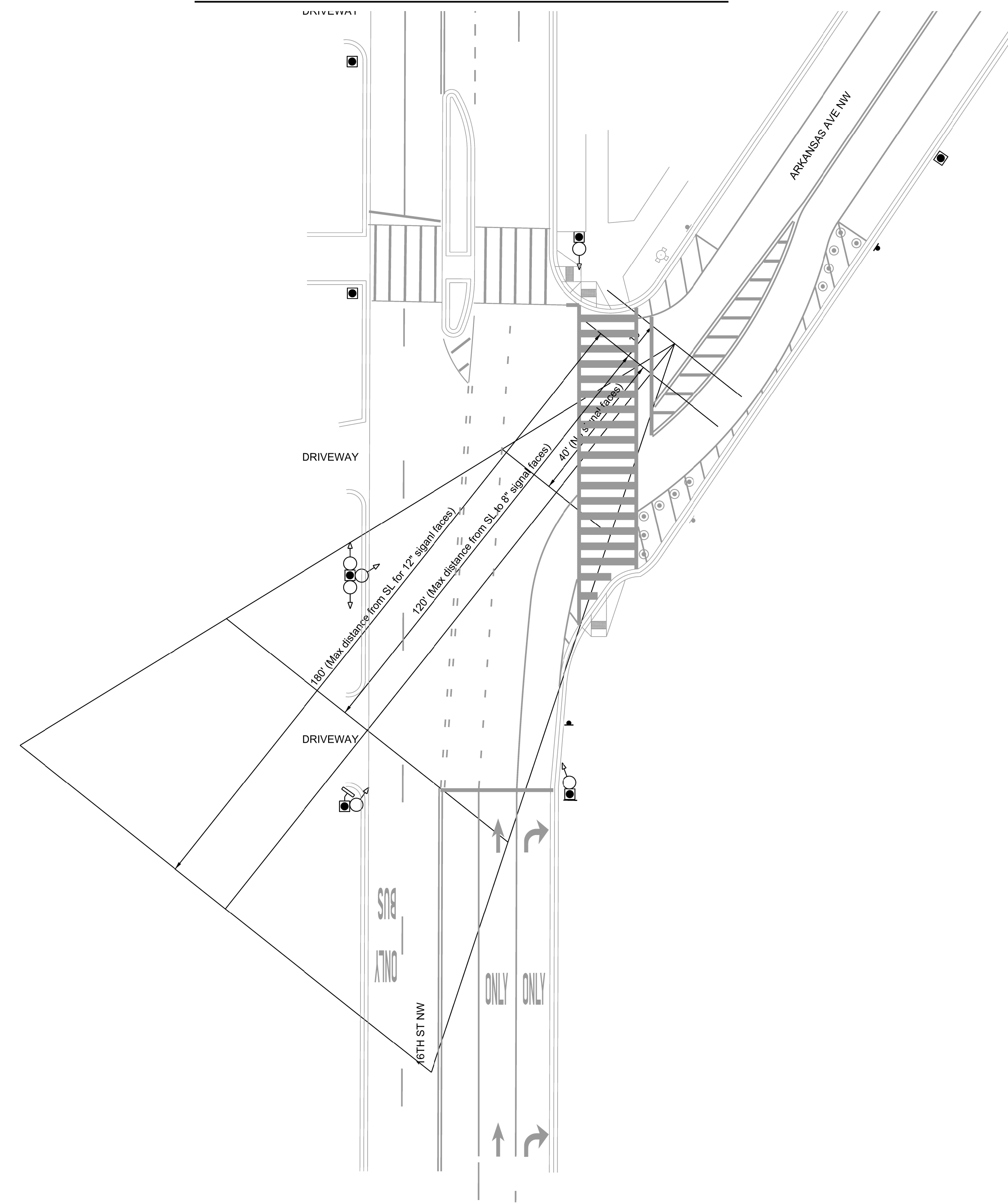

Sam Schwartz
A TYLin Company

NO.	DESCRIPTION	NAME	DATE

D.C. DEPARTMENT OF TRANSPORTATION
PROJECT DELIVERY ADMINISTRATION
TRAFFIC ENGINEERING AND SAFETY DIVISION

16TH STREET NW & ARKANSAS AVE NW
SAFETY IMPROVEMENTS

TRAFFIC SIGNAL VISIBILITY ANALYSIS

PROJECT ENG. <u>JC</u> DESIGNED BY <u>JC</u> CHECKED BY <u>W</u> DRAWN BY <u>JC</u> PROJECT MGR <u>W</u>	DIVISION CHIEF
DATE <u>AUGUST 2023</u>	
FILE <u> </u>	
SHEET <u>3</u> OF <u>3</u>	